

Installation Instructions



Step 1.
Remove stock shift knob by turning counter clockwise and remove shift boot and console cover.



Step 2.
Disconnect the primary center cable by removing the pin from the shifter shaft.



Step 3.
Disconnect the secondary cable by removing the pin from secondary cable arm.



Step 4.
Use a flat head screwdriver to pop the 2 locking clips located in the front of the assembly.



Step 5.
Lift up and Slide Out the main and the secondary cable.



Step 6.
Unbolt all four bolts to remove the whole assembly.

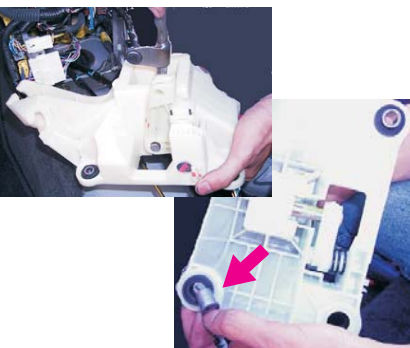

Step 7.
Remove whole assembly and transfer over rubber bushings and metal retainers to the new assembly.

Step 8.
Reverse procedures.